

Toucan Eco Active Plus operation guide

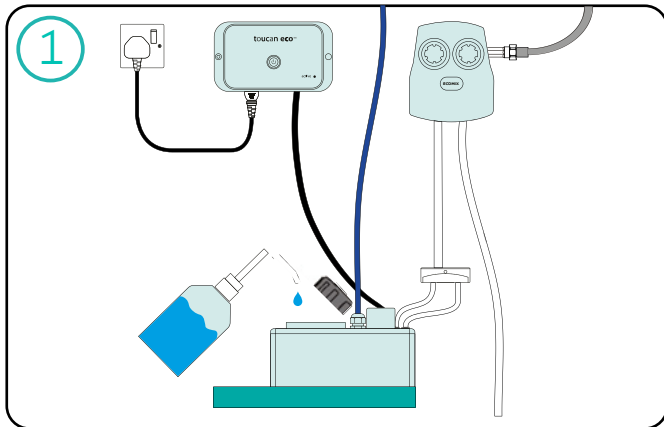

1 Unscrew the black lid from the empty 5L tank. Add two pumps (2 x 30ml) from the brine solution container. There shouldn't be any water in the tank at this stage.

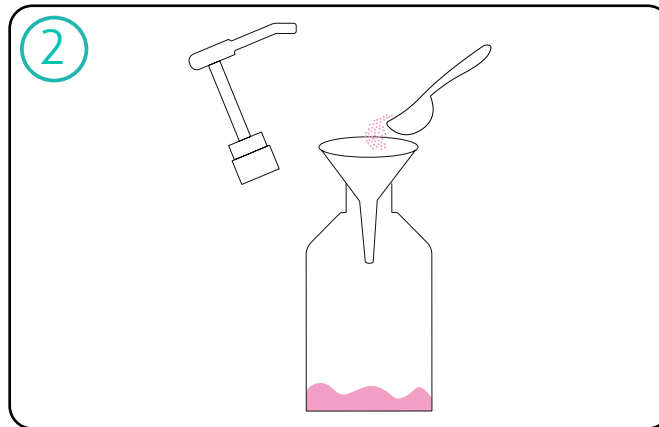

2 If the salt in the brine bottle has dissolved or the water level is low simply add more salt (to around 5cm level) or water. As long as you can see the salt in the bottom of the water this means it's supersaturated and the correct measure is used.

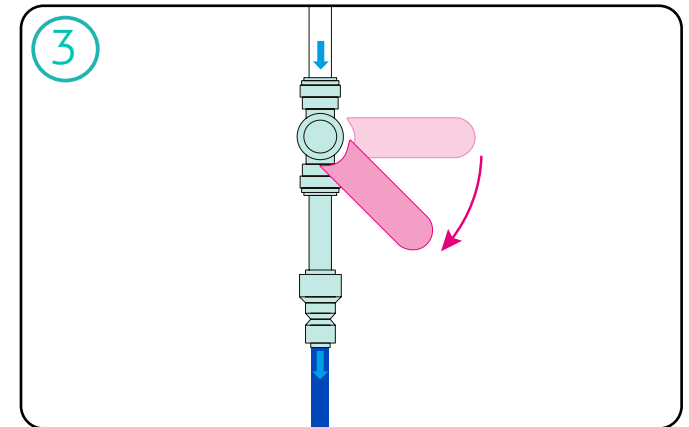

3 Open the lever valve to fill the tank up to the 5L mark.

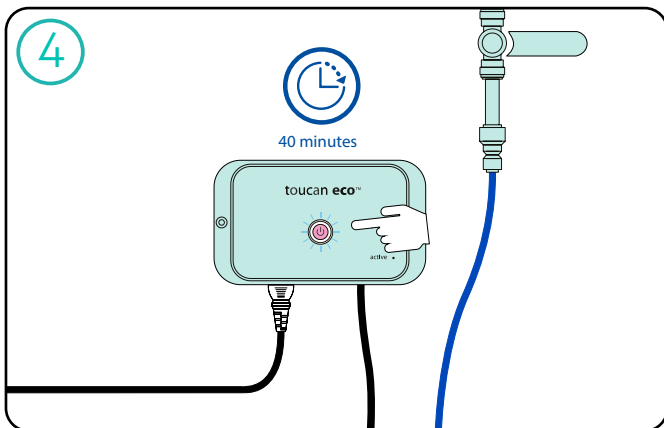

4 Switch on the activator unit; the switch is on the underside of the unit. The unit's light button will show green. To activate press the green light button. It will turn blue and the activation process starts, which takes 40 minutes.

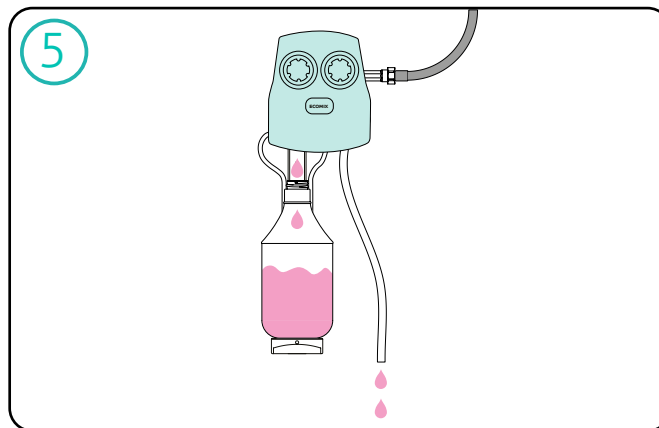

5 When the solution is activated the unit will beep and the blue light returns to green. The solution is now ready to dispense. The dispensers are set to deliver 20L at 200ppm via the bottle dispenser and 40L at 100ppm via the hose dispenser.

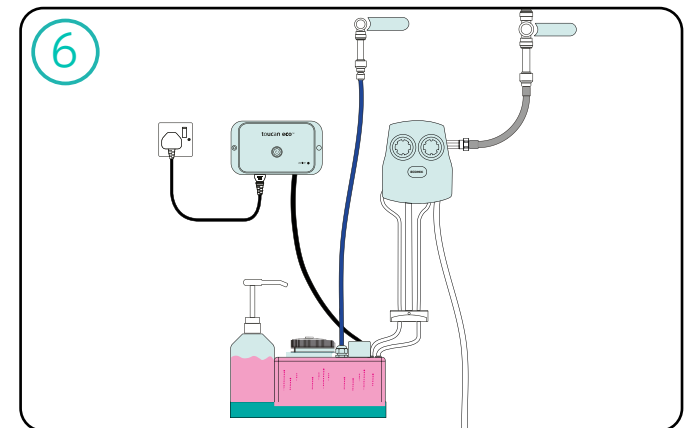

6 To make more solution, simply repeat this process again.